

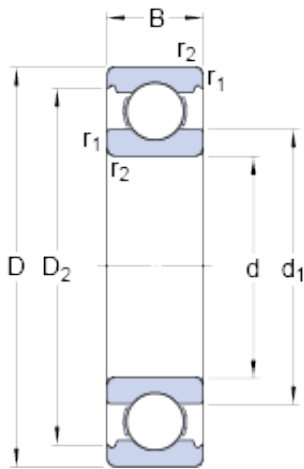

KOYO BEARINGS POLSKA Sp.Z O.o.



6317 Bearing 2D drawings and 3D CAD models

Rich Inventory SKF Bearing 6317 2RS1 6300
2RS1 6205 2RS1 6301 2RS1

Bearing No. 6317

Size	180x85x41 mm
Bore Diameter	180 mm
Outer Diameter	85 mm
Width	41 mm
d	85 mm
D	180 mm
B	41 mm
d ₁	114.55 mm
D ₂	155.4 mm
r _{1,2} - min.	3 mm
d _a - min.	99 mm
D _a - max.	166 mm
r _a - max.	2.5 mm
Basic dynamic load rating - C	140 kN
Basic static load rating - C ₀	96.5 kN
Fatigue load limit - P _u	3.6 kN
Reference speed	8000 r/min
Limiting speed	5000 r/min
Calculation factor - k _r	0.03
Calculation factor - f ₀	13.3
Category	Single Row Ball Bearings
Inventory	1.0
Manufacturer Name	SKF
Minimum Buy Quantity	N/A



KOYO BEARINGS POLSKA Sp.Z O.o.

Weight / Kilogram	4.3
EAN	7316570154702
Product Group	B00308
Enclosure	Open
Precision Class	ABEC 1 ISO P0
Maximum Capacity / Filling Slot	No
Rolling Element	Ball Bearing
Snap Ring	No
Internal Special Features	No
Cage Material	Steel
Internal Clearance	C0-Medium
Inch - Metric	Metric
Long Description	85MM Bore; 180MM Outside Diameter; 41MM Outer Race Diameter; Open; Ball Bearing; ABEC 1 ISO P0; No Filling Slot; No Snap Ring; No Internal Special Features
Category	Single Row Ball Bearing
UNSPSC	31171504
Harmonized Tariff Code	8482.10.50.68
Noun	Bearing
Keyword String	Ball
Manufacturer URL	http://www.skf.com
Manufacturer Item Number	6317
Weight / LBS	9.46
Outer Race Width	1.614 Inch 41 Millimeter
Bore	3.346 Inch 85 Millimeter
Outside Diameter	7.087 Inch 180 Millimeter
d ₁	114.55 mm
D ₂	155.4 mm
r _{1,2} min.	3 mm



KOYO BEARINGS POLSKA Sp.Z O.o.

d_a min.	99 mm
D_a max.	166 mm
r_a max.	2.5 mm
Basic dynamic load rating C	140 kN
Basic static load rating C_0	96.5 kN
Fatigue load limit P_u	3.55 kN
Calculation factor k_r	0.03
Calculation factor f_0	13.3
Mass bearing	4.25 kg